



Stainless Steel Pumps

Model BEST ONE Domestic Submersible Sump Pumps

Best One MA
Automatic pump with Float Switch

All Stainless Steel with Mechanical Seal



Specifications

- Submersible pump with semi open impeller
- Maximum liquid temperature: 50 °C
- Maximum submergence: 5 m

Materials

- Pump casing: 304 Stainless Steel
- Impeller: 304 Stainless Steel
- Outer casing: 304 Stainless Steel
- Shaft: 303 Stainless Steel
- Motor frame: 304 Stainless Steel
- Motor Cap: 304 Stainless Steel
- Seal: Carbon/Ceramic Mechanical Seal in oil lubricated chamber, Upper Lip Seal

Motor Data

- Air filled, dry submersible, 2 pole, 50 Hz
- Insulation class F
- IP68 protection
- 1 Phase - 230 Volt
- In built overload protection

Range

- 32 mm Ø discharge
- 0.25 kW
- Single phase, automatic or manual versions
- Magnetic Switch version available (for clean water)

Supply

- 5 m of cable with 3 pin plug

Accessories

- Low level suction skirt (for manual model)

Domestic sump pump manufactured in 304 stainless steel and with a mechanical shaft seal for reliability. Suitable for many light dewatering applications including:- • draining wells, basements, cellars, etc. • emptying of tanks & drums • general transfer of clean water.

Performance Curve

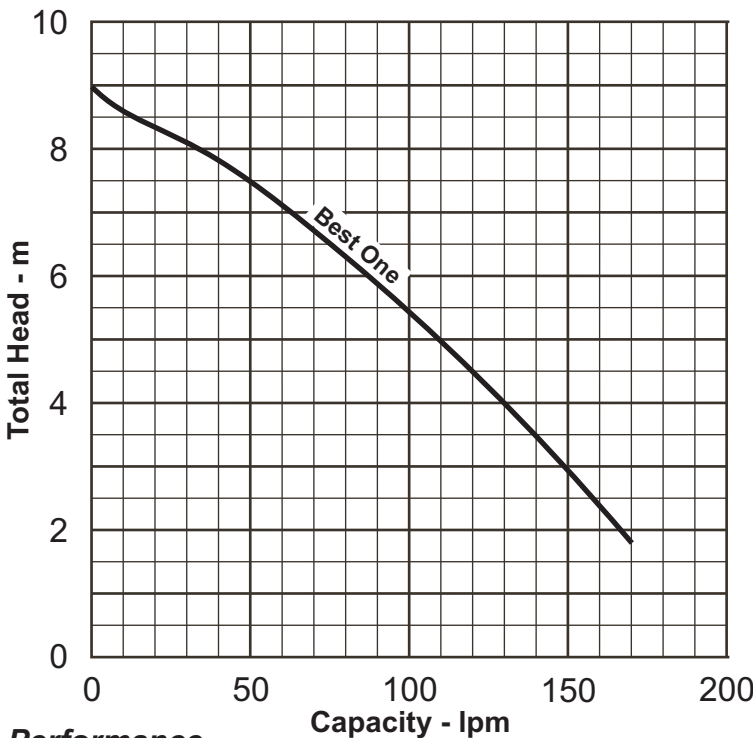

Performance Table

Pump Model	Motor Output	Discharge Ø mm	Power Supply	Full Load Current	Capacitor	Capacity - lpm						
						0	20	40	80	120	160	170
Best One	0.25 kW	32 mm	230 V, 50 Hz, 1 PH	2.3 A	8 µF	Total Head - m						
						9.0	8.3	7.8	6.3	4.5	2.4	1.8



Best One MS
Automatic pump with Magnetic Switch



Best One M
Manual Pump



Low level suction "skirt" (down to 3 mm)



(for manual model)

Sectional Drawing

Model **BEST ONE**

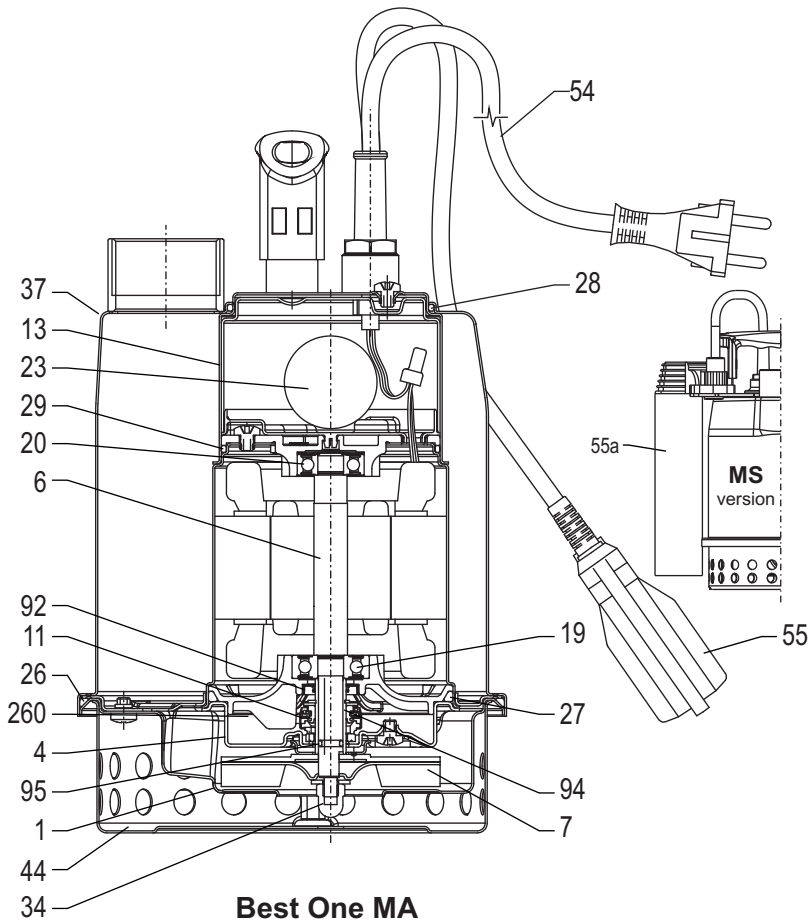

No.	Description	Material	Qty.
1	Casing	304 Stainless Steel	1
4	Casing cover	304 Stainless Steel	1
6	Shaft with rotor [#]	303 Stainless Steel	1
7	Impeller	304 Stainless Steel	1
11	Mechanical seal	Carbon/Ceramic/NBR	1
13	Motor cover	304 Stainless Steel	1
19	Lower bearing	Sealed Ball Bearing	1
20	Upper bearing	Sealed Ball Bearing	1
23	Capacitor	-	1
26	O-Ring	NBR Rubber	1
27	O-Ring	NBR Rubber	1
28	O-Ring	NBR Rubber	1
29	O-Ring	NBR Rubber	1
34	Impeller nut	303 Stainless Steel	1
37	Outer casing	304 Stainless Steel	1
44	Strainer	304 Stainless Steel	1
54	Submersible power cable	H05W-F	1
55	Float switch	(for MA version only)	1
55a	Float switch	(for MS version only)	1
92	Lip seal	NBR Rubber	1
94	Shaft sleeve	Ceramic coated 303 S/Steel	1
95	O-Ring	NBR Rubber	1
260	Oil	Esso MARCOL 152	40 ml

- refers to pump side of shaft material

Best One MA

Dimensions

Model **BEST ONE**

Units: mm unless otherwise specified

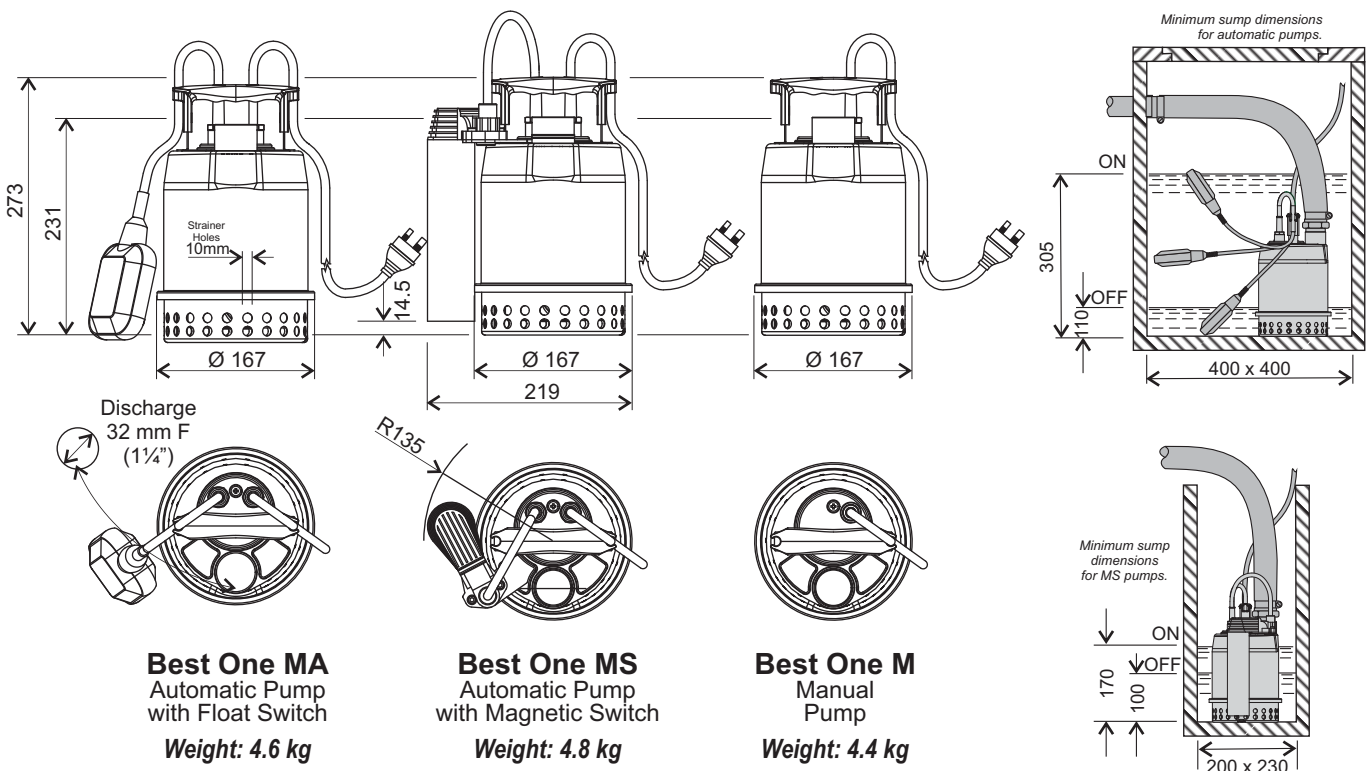

Best One MA
Automatic Pump
with Float Switch
Weight: 4.6 kg

Best One MS
Automatic Pump
with Magnetic Switch
Weight: 4.8 kg

Best One M
Manual
Pump
Weight: 4.4 kg

Specifications subject to change without notice